

FFHP Series

High pressure flat face couplers fitted with a safety locking sleeve

Introduction

AKJia's FFHP Series flat face couplers provide a leak free solution for high pressure applications up to 720 bar. The safety locking sleeve prevents accidental disconnection and can only be disconnected when the release notch and locking ball align.

Construction

- Carbon steel with trivalent plating
- Option: Carbon steel with zinc nickel plating (500 hours with no red rust in salt spray tests)
- Fitted with Nitrile seals (NBR)

Features

- Spring loaded safety locking sleeve fitted to prevent accidental disconnection, which automatically rotates through 90° when connected
- Flat faces are easily wiped clean
- Allows for minimal inclusion of air and contaminants during connection
- Flat face design prevents fluid loss during disconnection
- Bidirectional flow

Application

- High pressure plant and equipment
- High pressure pulse applications
- Rail industries; especially on de-stressing kits
- Bolt tensioning
- Cutting tools
- Jacking applications



Specifications

Seal Material	Min. Temp		Max. Temp	
Nitrile seals*	-40°C	-40°F	106°C	223°F



Product Number Naming Rules

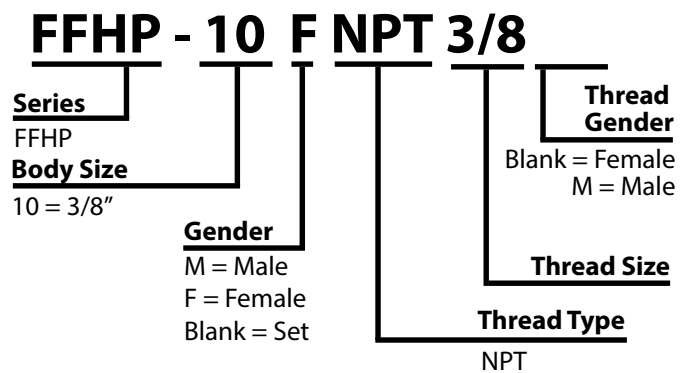

Drawing

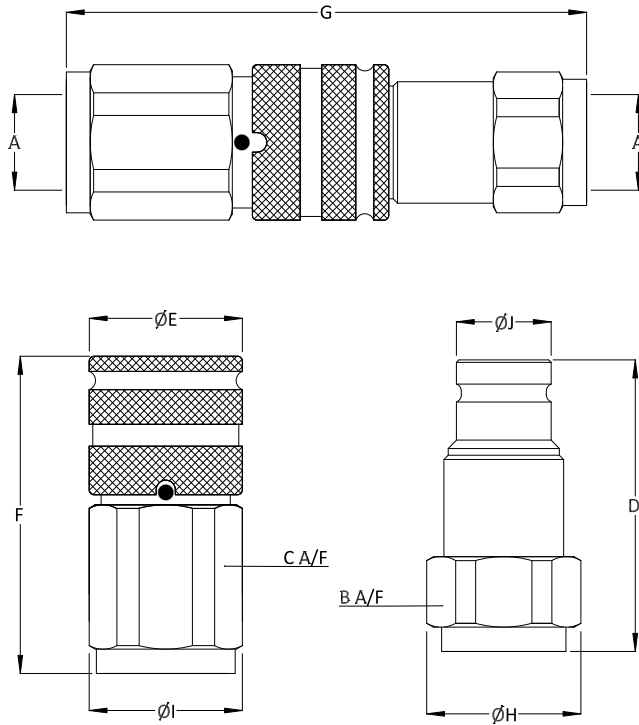

Pressure Drop Characteristics

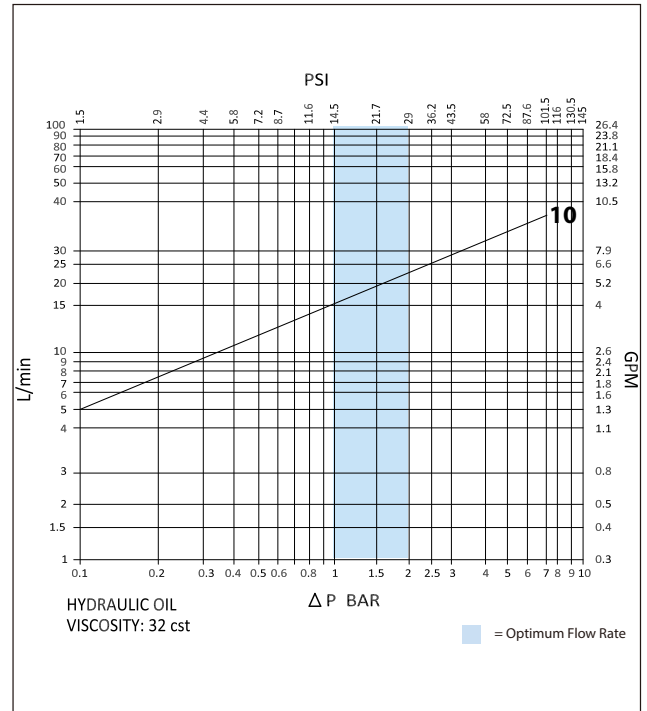

Size	Thread Size (A)	B	C	D	ϕE	F	G	ϕH	ϕI	ϕJ	Maximum Working Pressure	Burst Pressure (coupled)	Burst Pressure (Male)	Burst Pressure (Female)
Dimensions in mm											Bar			
Dimensions in inches											Psi			
FFHP-10	3/8" NPT	27	30	63	34	74.5	121.5	29	32	19.5	720	2000	2000	1500
		1.1	1.2	2.5	1.3	2.9	4.8	1.1	1.3	0.8	10440	29000	29000	21750