

H Series

Poppet style couplers with a guided poppet

Introduction

AKJia's HTN Series poppet style couplers are a reliable and efficient option for use across a wide range of hydraulic applications. Faster TNV Series, Snap-tite H Series Interchange

Construction

- Carbon steel with trivalent plating
- Fitted with Nitrile seals - NBR

Features

- Poppet style minimizes pressure drop and creates an effective seal while allowing high flow rates
- Elongated nose and poppet design allows for simple connection and disconnection
- Bidirectional flow

Application

- Machine tools
- Test equipment
- General hydraulic system, agricultural and mobile hydraulics



Product Number Naming Rules

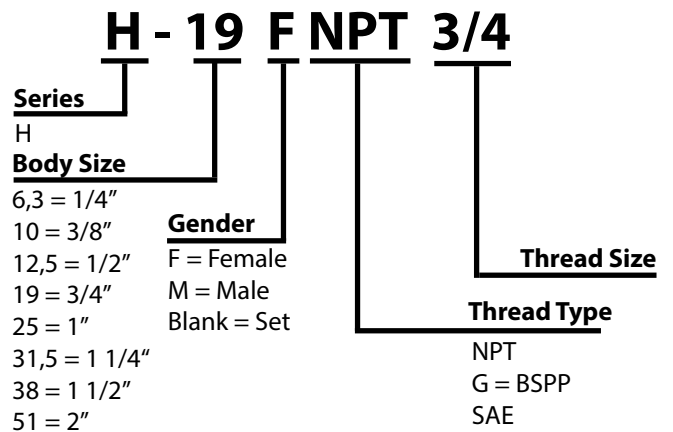

Specifications

Seal Material	Min. Temp		Max. Temp	
	-40°C	-40°F	106°C	223°F
Nitrile seals*				

Drawing

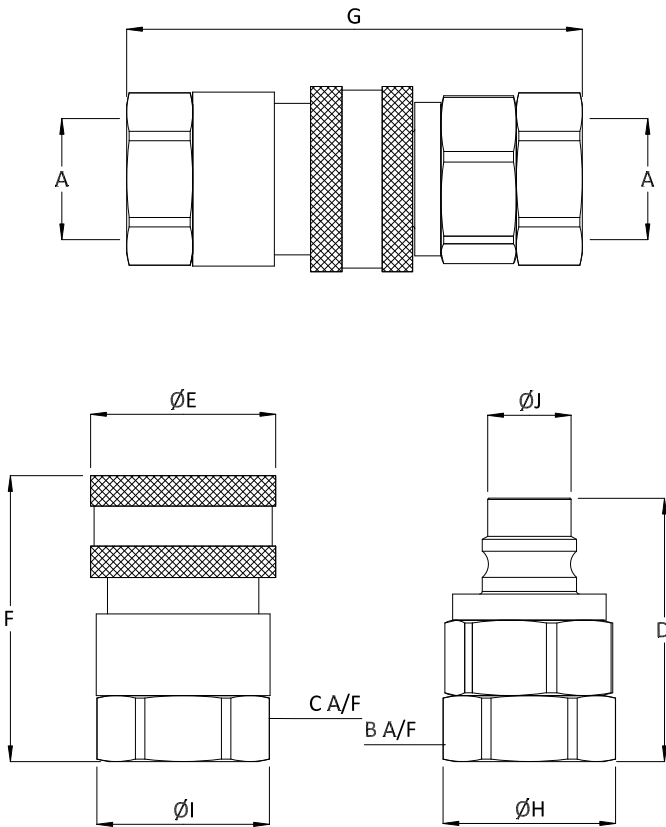

Pressure Drop Characteristics

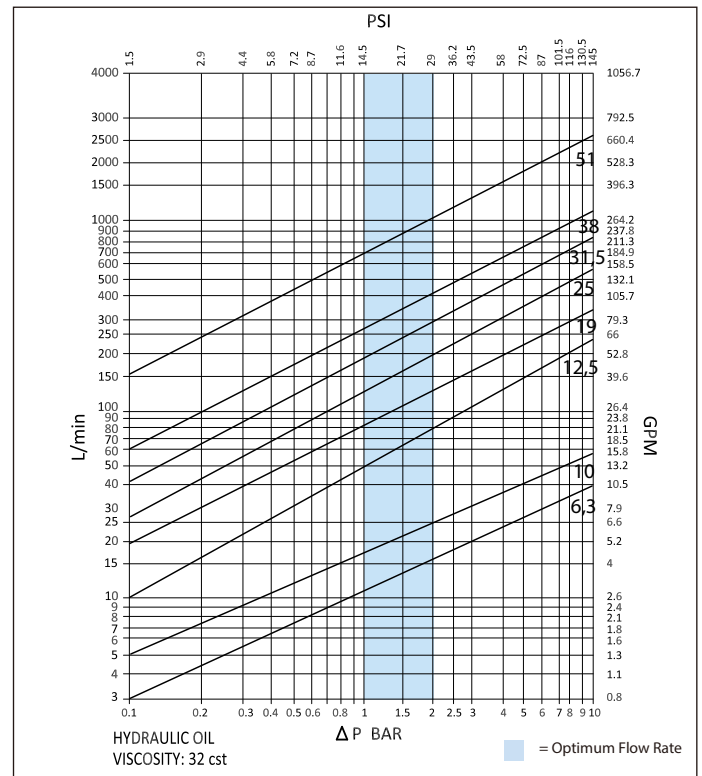

Size	Thread Size (A)	B	C	D	ØE	F	G	ØH	ØI	ØJ	Maximum Working Pressure	Burst Pressure (coupled)	Burst Pressure (Male)	Burst Pressure (Female)
Dimensions in mm											Bar			
Dimensions in inches											Psi			
H-6,3	1/4"	22	22	41.3	24	44	70.3	24.5	24.5	10.9	450	1350	1350	1250
		0.9	0.9	1.6	0.9	1.7	2.8	1	1	0.4	6527	19575	19575	18125
H-10	3/8"	26	26	47	27	49.4	78.5	28.1	28.1	12.9	350	1050	1050	950
		1	1	1.9	1.1	1.9	3.1	1.1	1.1	0.5	5076	15225	15225	13775
H-12,5	1/2"	30	30	51	34	53.5	87.3	33	33	15.9	300	900	900	800
		1.2	1.2	2	1.3	2.1	3.4	1.3	1.3	0.6	4351	13050	13050	11600
H-19	3/4"	38	38	62	42	63	104	41.9	41.9	23.4	250	750	750	650
		1.5	1.5	2.4	1.7	2.5	4.1	1.6	1.6	0.9	3626	10875	10875	9425
H-25	1"	48	48	66.8	50.5	68.3	112.5	52.5	52.5	29.7	200	600	600	500
		1.9	1.9	2.6	2	2.7	4.4	2.1	2.1	1.2	2901	8700	8700	7250
H-31,5	1 1/4"	50	50	88	56	91	156.5	55.9	55.9	36.1	150	450	450	350
		2	2	3.5	2.2	3.6	6.2	2.2	2.2	1.4	2176	6525	6525	5075
H-38	1 1/2"	64	64	85.6	70	90	148.2	69.5	69.5	43.3	130	390	390	290
		2.5	2.5	3.4	2.8	3.5	5.8	2.7	2.7	1.7	1885	5655	5655	4205
H-51	2"	89	89	99	90	105	171	97.4	97.4	56.7	100	300	300	200
		3.5	3.5	3.9	3.5	4.1	6.7	3.8	3.8	2.2	1450	4350	4350	2900