

# SP Series

## High pressure screw connect couplers

### Introduction

AKJia's SP Series screw connect couplers are designed for heavy duty applications involving very high pressures and severe pressure pulses.

### Construction

- Carbon steel with trivalent plating
- Fitted with Nitrile seals
- Also available in AISI 316 (SPS Series) stainless steel

### Features

- Screw to connect design eliminates brinelling
- Can be connected with up to 50 bar (735 psi) residual pressure in the hydraulic circuit
- Bidirectional flow

### Application

- Hydraulic jacks
- Hydraulic hammers
- Construction plant
- Mobile equipment,
- Demolition
- Agricultural industries



### Product Number Naming Rules

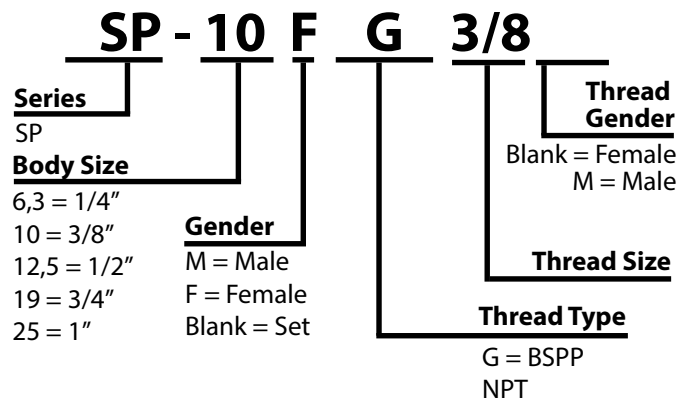

### Specifications

Seal Material	Min. Temp		Max. Temp	
	-40°C	-40°F	106°C	223°F
Nitrile seals*				

**Drawing**

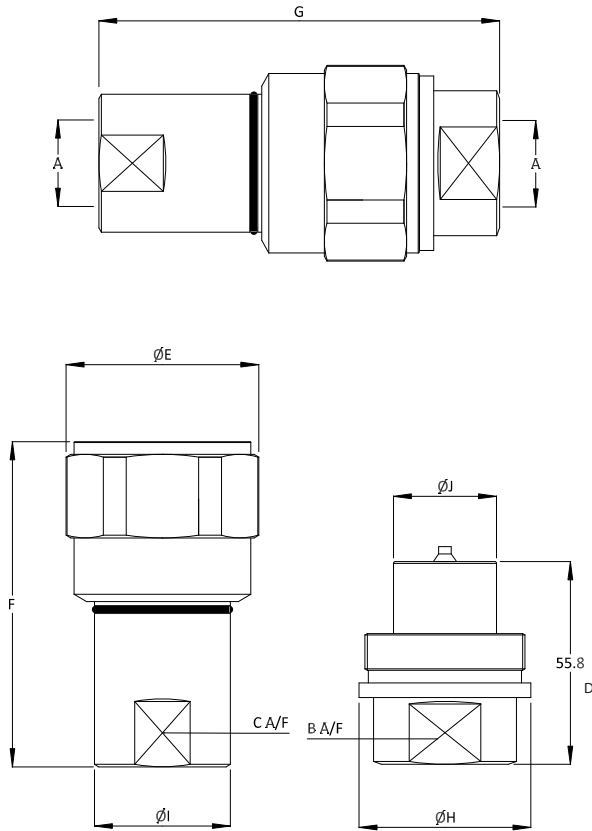

**Pressure Drop Characteristics**

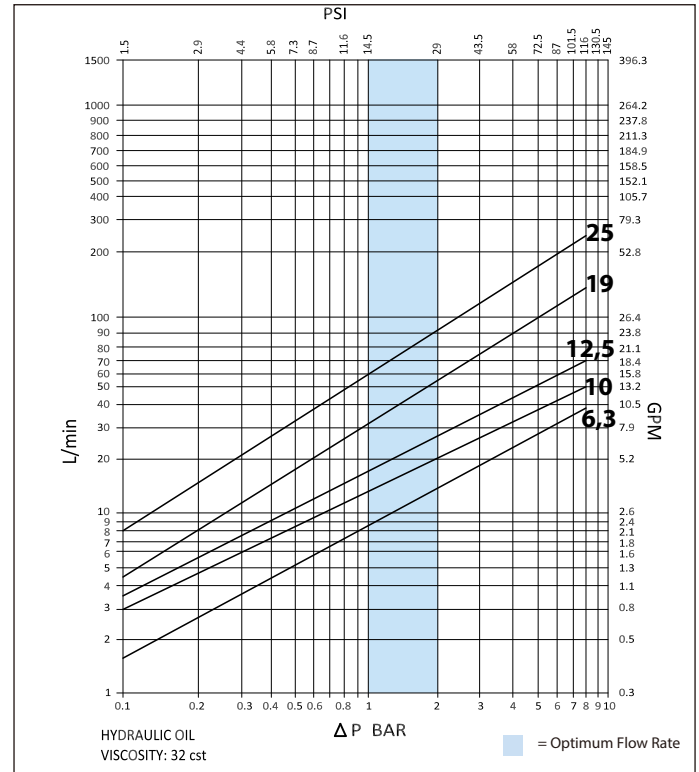

Size	Thread Size (A)	B	C	D	ØE	F	G	ØH	ØI	ØJ	Maximum Working Pressure	Burst Pressure (coupled)	Burst Pressure (Male)	Burst Pressure (Female)
Dimensions in mm											Bar			
Dimensions in inches											Psi			
SP-6,3	1/4"	19	19	36	35	59	72	29	21	15	950	3800	3650	3500
		0.7	0.7	1.4	1.4	2.3	2.8	1.1	0.8	0.6	13775	55100	52925	50750
SP-10	3/8"	22	22	40.5	39.5	67	81.5	31	25	19	750	3000	3000	2900
		0.9	0.9	1.6	1.6	2.6	3.2	1.2	1	0.7	10875	43500	43500	42050
SP-12,5	1/2"	27	27	49.5	44	76.5	98	38	30	22	750	3000	2950	3000
		1.1	1.1	1.9	1.7	3	3.9	1.5	1.2	0.9	10875	43500	42775	43500
SP-19	3/4"	35	35	56	54	90	112	48	38	29	650	2600	2520	2500
		1.4	1.4	2.2	2.1	3.5	4.4	1.9	1.5	1.1	9425	37700	36540	36250
SP-25	1"	41	41	66	73	105.5	132.5	59	48	36	450	1800	1800	1650
		1.6	1.6	2.6	2.9	4.2	5.2	2.3	1.9	1.4	6525	26100	26100	23925